

Creek Courses beg<sup>d</sup> at W: Thorn

N 23° E 10

N 7° E 14.8

N 20° W 92

N 40° W 56.5

N 60° W 14 to a White Oak

187.3

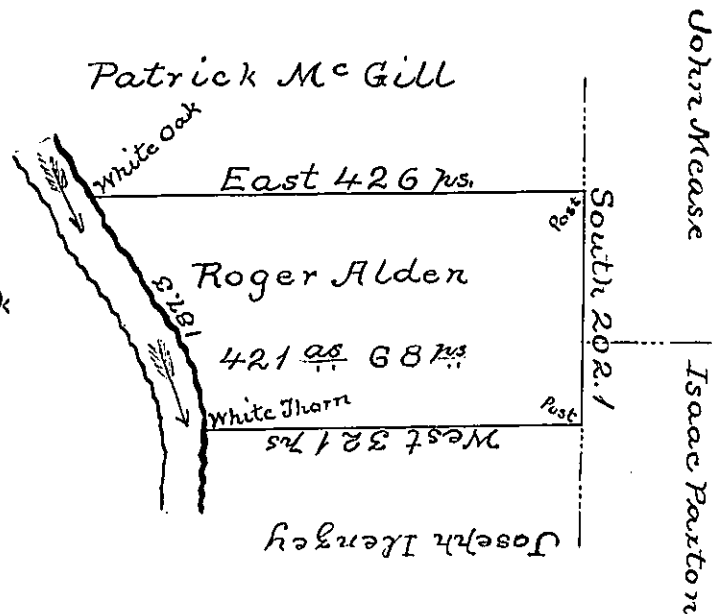

In pursuance of a Warrant for 400 <sup>ac.</sup> dated the 6<sup>th</sup> day of June 1801, was surveyed the 17<sup>th</sup> day of July 1801, for Roger Alden the above described Tract of land containing 421 acres 68 perches and allowance of six per cent for Roads &c. Situate on the East side and adjoining French Creek in Mead Township Crawford County. It being the same tract of land that was surveyed for a certain John Fredebaugh the 11<sup>th</sup> day of November 1794, in pursuance of his Improvement dated the 3<sup>rd</sup> day of April 1792.

To.

Samuel Cochran Esquire  
Surveyor General

William McArthur Sr.

IN TESTIMONY that the above is a copy of the original remaining on file in the Department of Internal Affairs of Pennsylvania, made conformably to an Act of Assembly approved the 16th day of February, 1833, I have hereunto set my Hand and caused the Seal of said Department to be affixed at Harrisburg, this

ninth day of January 1885.

J. Simpson Africa,  
Secretary of Internal Affairs